

Copyright © BergerABAM. All Rights Reserved.

Last Saved by: Garth Nelson on: Jan 14, 2014 6:24 AM File: C:\Federal\Way2010\FAWAT-10-501\CADD\DWG\BARGE DOCK EXTENSION\G-03.dwg

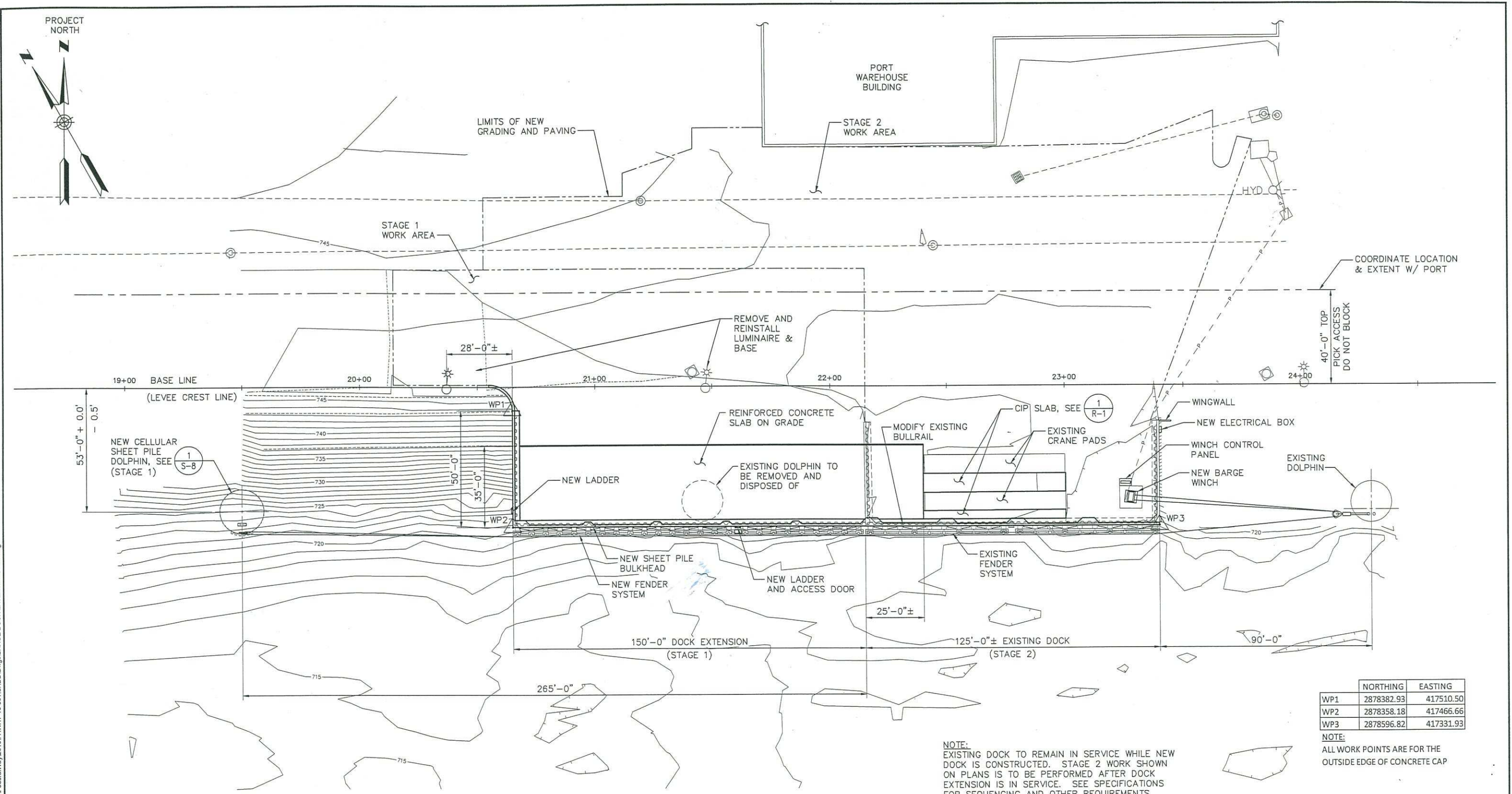

| | NORTHING | EASTING |
|-----|------------|-----------|
| WP1 | 2878382.93 | 417510.50 |
| WP2 | 2878358.18 | 417466.66 |
| WP3 | 2878596.82 | 417331.93 |

NOTE:
EXISTING DOCK TO REMAIN IN SERVICE WHILE NEW DOCK IS CONSTRUCTED. STAGE 2 WORK SHOWN ON PLANS IS TO BE PERFORMED AFTER DOCK EXTENSION IS IN SERVICE. SEE SPECIFICATIONS FOR SEQUENCING AND OTHER REQUIREMENTS.

1 PLAN - GENERAL ARRANGEMENT
SCALE: 1" = 20'-0"

1"=20' scale 0 20 40 feet

RECORD DRAWINGS

| MARK | REVISION DESCRIPTION | BY | APP. | DATE |
|------|----------------------|-----|------|----------|
| 1 | RECORD DRAWINGS | GDN | DJ | 12/24/13 |

BergerABAM
33301 9th Avenue South, Suite 300
Federal Way, Washington 98003-2600
(206) 431-2300 Fax: (206) 431-2250

Port of Lewiston

PROFESSIONAL ENGINEER
REGISTERED
7587
STATE OF WA
ROBERT R. GRIEBENOW

DRAWN BY PIL
DESIGN BY JK
CHECK BY DJ
PROJ MGR DJ

PORT OF LEWISTON
DOCK EXTENSION
GENERAL ARRANGMENT

DRAWING NO. **G-3**
PROJECT NO. FAWAT-10-501
DATE: 5/3/13
SHEET NO. 3 OF 19